

TUTORIAL – APPLYING A FIBERFORCE MESH WITH THE EZ-VAC

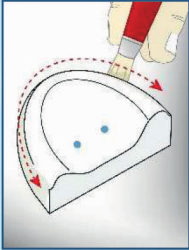

1- After outlining the edges of the model. Isolate your model

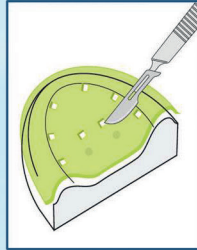

2- Apply self-adhesive wax and cut out holes for the confectioning of the spacers (according to instructions)

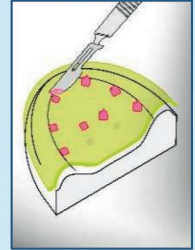
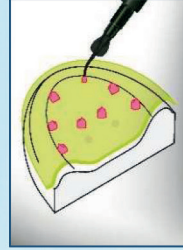

3- Fill holes with pink FIBERFORCE resin, remove excess and light cure

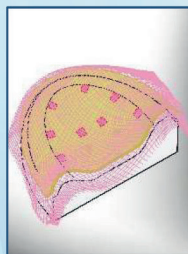
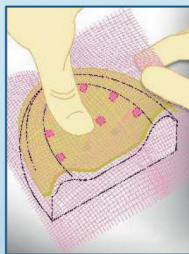
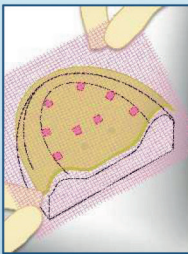

4- Place pink FIBERFORCE mesh on model

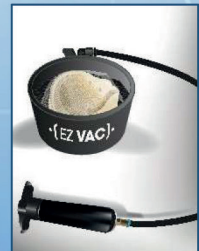

5- Place the whole into EZ-VAC system



6- Clamp EZ-VAC system with membrane and cover

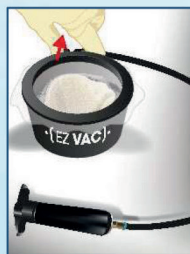
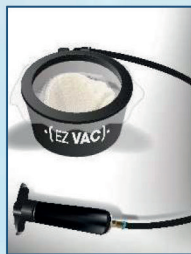

7- Make sure valve is open

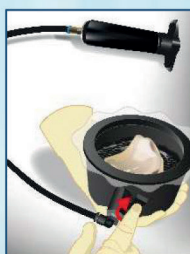

8- Using the pump, evacuate the air to press the mesh against the model and close valve

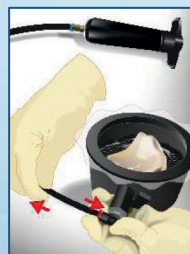

9- Disconnect the pump by pressing on the black collar of the fitting and pulling out the hose

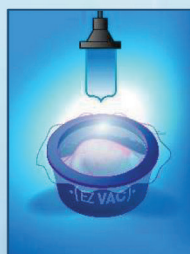

10- Cure inside a blue light curing machine (time according to instructions), cut the mesh and build your denture as wanted

Medical device for dental care reserved for health professionals.
Always read carefully the instructions given in the manual or on the label before use. Fiber Force Class IIA (CE marking issued by SGS) CE1639



104004014 D



BIO COMPOSANTS MÉDICAUX
215, route de Bavonne - ZA le Talamud
38140 Saint-Blaise-du-Buis
+33 (0)4 76 07 79 57

dentalbcm.com
contact@biomedicaux.com