



# biolight DUAL™

DOUBLE-TAPERED POST ADAPTED TO THE ROOT CANAL MORPHOLOGY

# biolight ST™

CYLINDRICAL-CONICAL FIBRO ARCHITECTURED POST

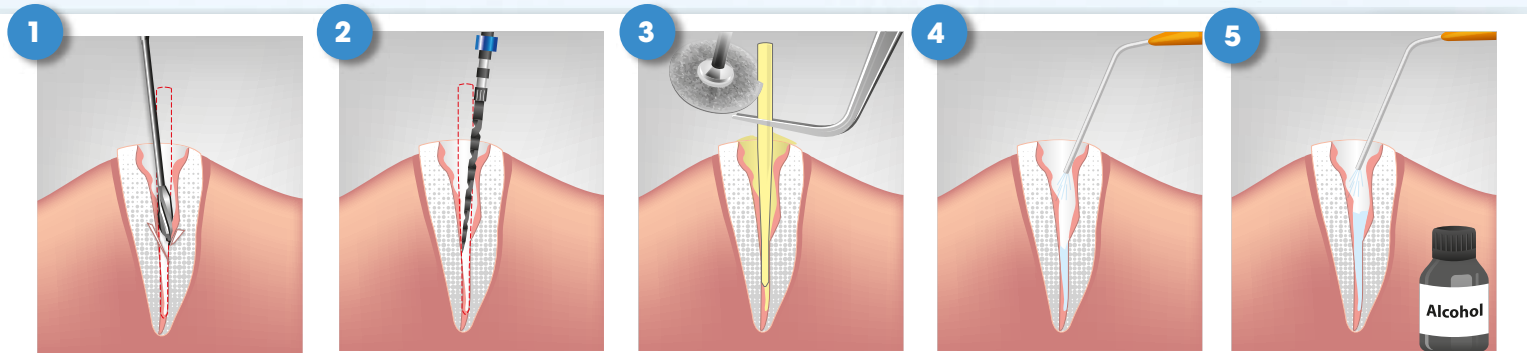

1 Unseal and shape the canal using a "Gates" drill (in the desired post diameter). Use the Biolight Dual/ST reamer in the desired shape.

3 Try the selected post and shorten it to give it the proper occlusal length.

4 Rinse and dry.

5 Etch, rinse and dry.

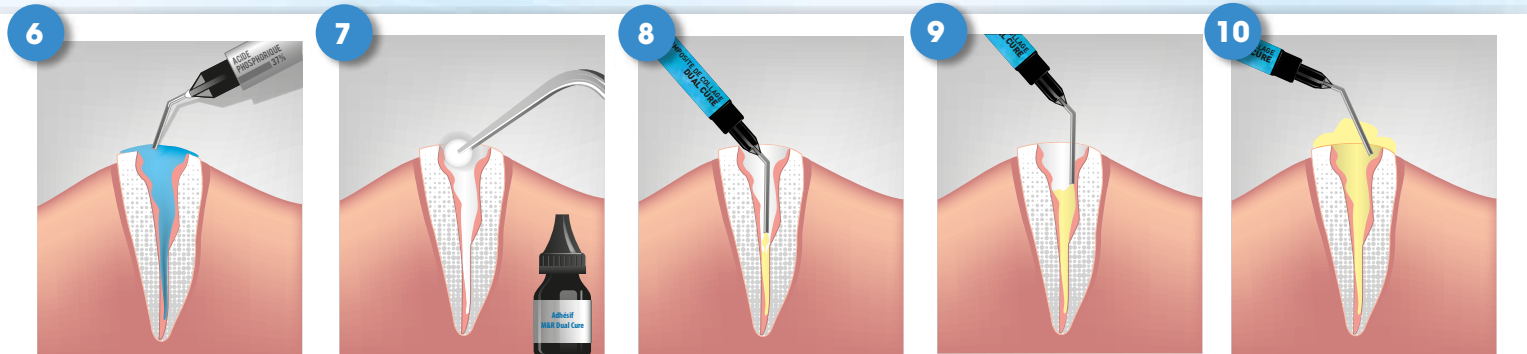

6 Apply an adhesive on the root canal walls.

7 Fill the root canal in retrograde with a dual composite.

9 Disinfect using alcohol and dry

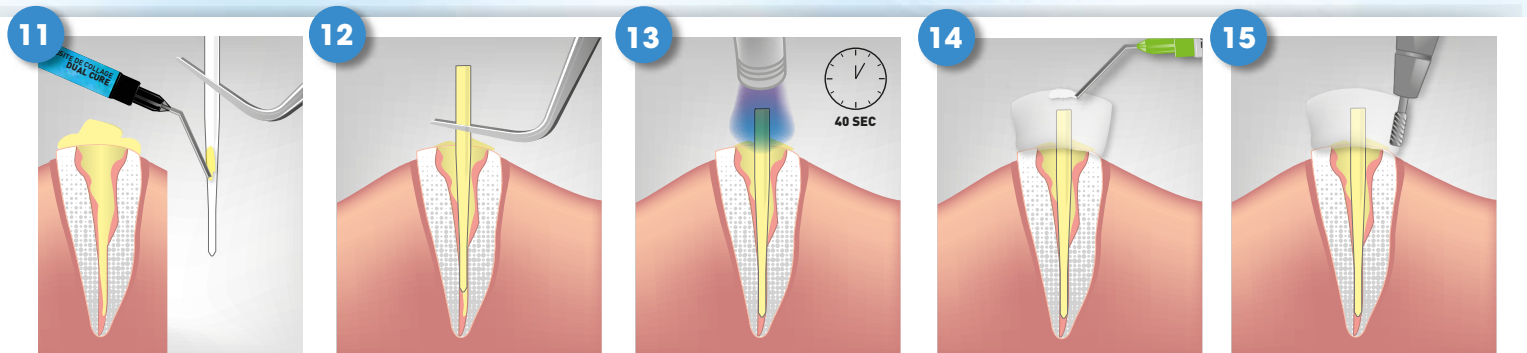

11 Coat the post.

12 Insert the post in the root canal perfectly adapted to its size.

13 Maintain the pressure and light cure. 40 SEC

14 Create the coronal stump with a reconstruction composite, accordingly.

15 Shape the coronal stump.

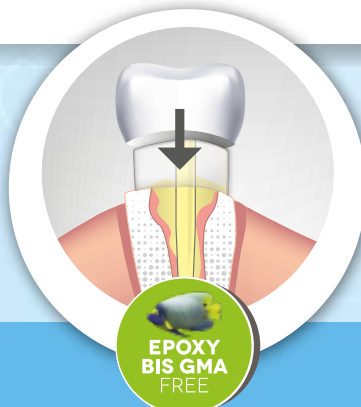

EPOXY BIS GMA FREE

Dental care medical device reserved for health professionals, not reimbursed by health insurance. Please carefully read the instructions in the notice or on the labelling prior to use. Class: IIA (CE marking delivered by SGS) CE1639.

BIOLIGHTDUAL/ST\_TUTO\_EN\_08042021



**BIO COMPOSANTS MÉDICAUX**  
215, route de Bavonne - ZA le Talamud  
38140 Saint-Blaise-du-Buis  
+33 (0)4 76 07 79 57

**dentalbcm.com**  
contact@biomedicaux.com